

smanos®

Ceiling-Mounted PIR Motion Detector

MD7000

User Manual

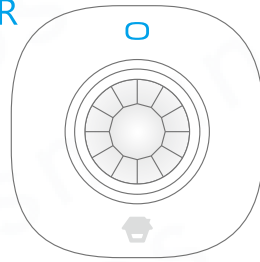

Product Overview

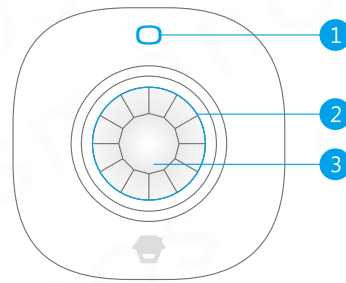

1. Test Button
2. Detection Lens
3. LED Indicator
4. Mounting Plate

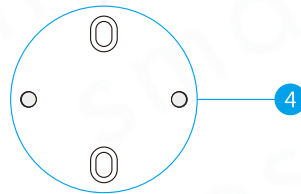

LED Indication

The LED indicator can be turned on or off by setting jumpers. See "PCB Layout" above.

Flash continuously: Under self-testing state

Flash once: Intruder is detected

Flash twice: Test mode is finished, enters power saving mode.

Flash once every 3 seconds: Low battery, please change the batteries immediately.

Introduction

The detector works based on detecting human body's infrared spectrum. When human moves within the scope, the detector receives the signal and inputs it into microprocessor after magnification. Microprocessor continues to sample infrared signal and send wireless signal to wireless control panel after calculating, thus to form a security system. The product can be applied in banks, warehouses and homes etc.

Features

Accurate Detection

360° detection, no dead angle

Automatic temperature compensation and anti-air turbulence technology

False Alarm Prevention

Digital dual-core fuzzy logic infrared control processing technology

Effectively identify interference signals from body movement signals through intelligent analysis

Space-saving

Ceiling-mounted, not much space occupation

Integrated to home decoration, suitable for luxury premises

Energy-saving

Featured power-saving mode enables 1 year standby

PCB Layout

Infrared Sensor

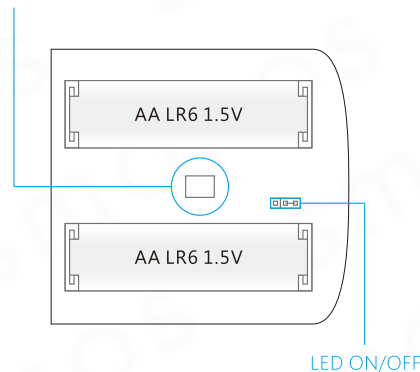

Infrared sensor: Detecting human body's infrared spectrum. Don't touch the surface by hand and keep it clean.

Detection Range

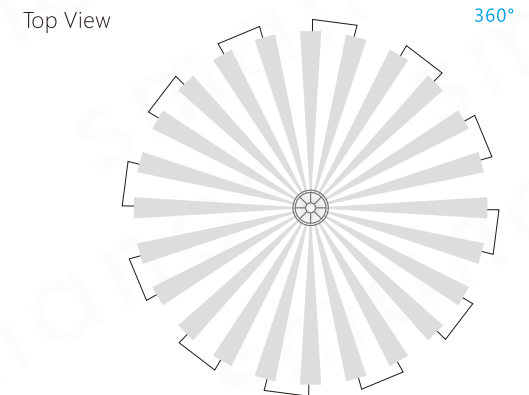
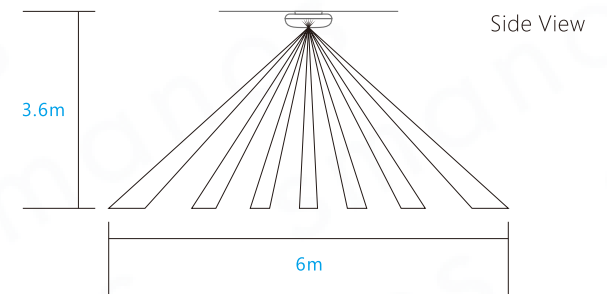

Usage

Remove the battery activation strip to activate batteries. It will enter working state after one-minute's self-testing.

Working Mode

Testing Mode: Press test button, the sensor enters testing mode and detects once every 10 seconds. After 3 minutes, the LED flashes twice, the sensor enters the power saving mode.

Power-Saving Mode: In working state, if the sensor is triggered twice within 3 minutes, it will enter sleeping mode to save power. After no movement within next 3 minutes, the sensor goes back to the working state.

Installation & Notice

Choose a suitable position and fix the mounting plate on the ceiling with screws. Fasten the detector on the mounting plate in a clockwise direction. It is suggested to mount it at the height of 2.5-5 meters from the ground.

Keep the detector away from air conditioner, electronic fan, refrigerator, oven, heater or any other objects which will cause fast temperature changing.

Avoid mounting it in direct sunlight or any objects blocking the lens, so as not to influence the detection effect.

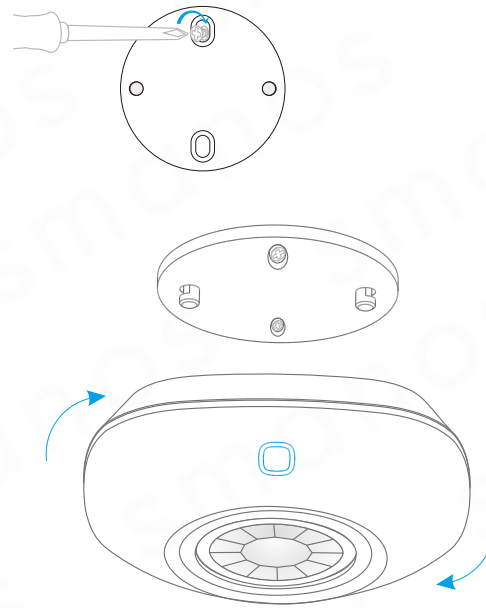

Testing (Walk Test)

After installation, power on the detector. After self-testing for 1 minute, press the test button, walk in the scope by crossing the infrared spectrum (see below diagram), and watch the LED indicator to make sure it is working. The LED indicator will flash once when body movement is detected.

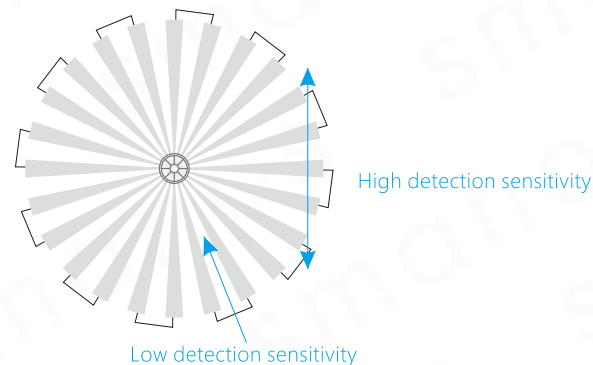

Connect with the Control Panel

When the control panel is in connecting state, press the test button twice to send wireless signal. One beep is heard after panel receives signal, which means successful connection.

Arm the system, trigger the detector again. The panel will alarm immediately. This indicates the detector has successfully connected with the panel.

Specifications

Power Supply:

DC 3V (AA LR6 1.5V Battery x 2pcs)

Static Current:

< 50uA

Alarm Current:

< 9.5mA

Installation Height:

2.5-6m

Detection Scope:

Dia. 6m (when installation height is 3.6m)

Transmitting Distance:

< 80m (in open area)

Radio Frequency:

868MHz or 915MHz

Housing Material:

PC+ABS Plastic

Operating Condition

Temperature: -10°C~+55°C

Relative Humidity: < 80% (non-condensing)

Detector Dimensions (L x W x H):

90 x 90 x 36.8mm

Mounting Plate Dimensions (L x W x H):

56 x 56 x 8mm

CHUANGO®

产品型号	MD7000	部件名称	说明书
设计	林寿	材料	80克书写纸
印刷尺寸	285X210mm	成品尺寸	95X70mm
工艺	折页	版本	Ver: MD7000-UM-EN-V1.0
<p>注: 双色、双面印刷 保持产品名称在最上面</p>			